

EYE SLIP HOOK

316 STAINLESS STEEL

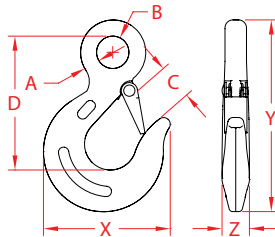

Import



Drop
Forged



Load
Rated



MIL-
SPEC

| ITEM | A (size) | B | C | D | X (height) | Y (length) | Z (width) | WLL (lb) | WT (lb) | PACKAGING TYPE | EACH (qty) | INNER (qty) | CARTON (qty) | UPC |
|------------|-------------|-------|-------|-------|---------------|---------------|--------------|-------------|------------|-------------------|---------------|----------------|-----------------|--------------|
| S0454-0007 | 1/4" | 0.53" | 0.68" | 2.54" | 2.57" | 3.63" | 0.60" | 1,000 | 0.50 | POLYBAG | 1 | 1 | 60 | 791506045335 |
| S0454-0008 | 5/16" | 0.65" | 0.75" | 2.86" | 2.90" | 4.14" | 0.70" | 1,500 | 0.70 | POLYBAG | 1 | 1 | 40 | 791506045342 |
| S0454-0010 | 3/8" | 0.71" | 0.80" | 3.28" | 3.43" | 4.87" | 0.77" | 2,000 | 1.18 | POLYBAG | 1 | 1 | 20 | 791506045359 |
| S0454-0013 | 1/2" | 0.94" | 1.02" | 4.17" | 4.60" | 6.38" | 1.02" | 3,000 | 1.87 | POLYBAG | 1 | 1 | 10 | 791506045366 |

NOTE:

MEETS THE REQUIREMENTS OF: MIL-DTL-32655. MEETS ASME B30.10-2010. WORKING LOADS ARE BASED ON GRADUAL PULL, NOT SHOCK LOADS. ALL DIMENSIONS ARE NOMINAL (+/- 3%) AND ARE SUBJECT TO CHANGE WITHOUT NOTICE.